



canflex (USA), Inc.

360 Gold Telemetry Load Links

With ALRS2 handset

Our answer to measurement of Tensile load in heavy industrial applications



Features of ALRS2 electronics

- 250 metre range
- Constant peak and actual load continually displayed
- 5 units of measurement, Te, Kgs, lbs, US Tons, kN
- Internal antenna
- Display light for easy viewing
- Fast update speed
- Simple battery change out
- Optional logging package
- Easy to use



Features of JCM Gold telemetry load links

- Full O'ring sealing
- Lightweight aerospace aluminium
- Flush covers
- Full traceable calibration
- Temperature compensated
- 360° radio output
- Units available from 2.5 to 500 Tonne
- 1 year battery life option on load link

360 Gold Telemetry Load Links

Our answer to measurement of Tensile load in heavy industrial applications

SIZE	A	B	C	D	E	WEIGHT
2.5 Tonne	23	215	120	270	25	2.4
5 Tonne	27	227	120	292	32	2.6
12.5 Tonne	44	226	130	324	50	5.3
25 Tonne	55	240	134	360	70	7.1
35 Tonne	62	290	140	440	70	9.4
55 Tonne	78	298	163	476	85	15.0
75 Tonne	86	306	190	500	100	17.0
100 Tonne	100	346	194	556	124	26.1
150 Tonne	120	396	244	680	127	47.1
200 Tonne	132	442	280	784	150	79.0
250 Tonne	146	466	300	844	150	TBA
300 Tonne	160	582	400	1000	150	TBA
400 Tonne	180	614	400	1098	200	TBA
500 Tonne	190	600	490	1100	200	TBA

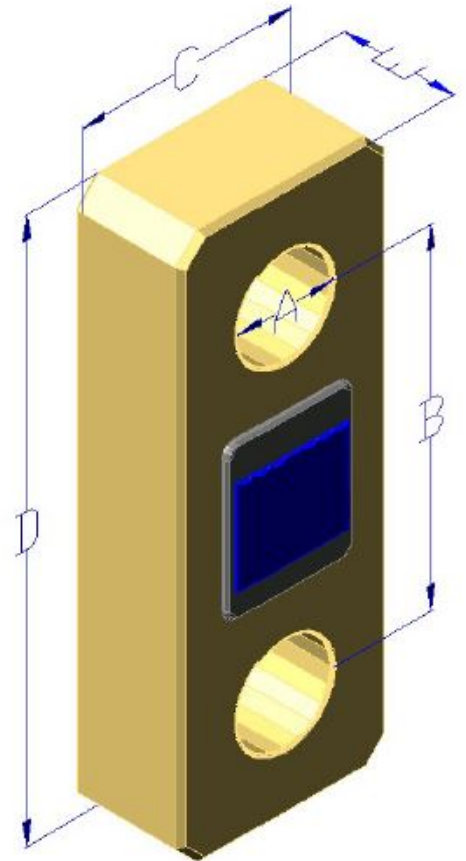

All sizes in mm
Please confirm any critical dimension before ordering



Units from 2.5 to 50 Tonne are supplied in an IP67 transit case,

75 to 500 Tonne units supplied in a hinged wooden transit crate, made with heat treated wood so ready for international shipping

We are able to supply direct from our factory or via our growing list of sales partners worldwide