



canflex (USA), Inc.

360 Gold Telemetry Load Links

Measurement of Tensile Load in Heavy Industry Applications

Load Cell Features

- Full O'ring Sealing
- Full 360° (200 meter) Signal Transfer
- Internal Antenna- No External Parts
- Linear Construction
- Reverse Voltage Protection
- 1000 Plus Hours Life on 3 x AA Batteries
- Fully Anodized Finish
- Simple Battery Change Out
- Capacities Available from 5 to 500 Tonne
- 5 to 50 Tonne Units are Supplied in a Case
- 75 to 500 Tonne in a Hinged Wooden Crate
- Four Switch Able Units Lbs/Tons/ Kgs/ Tonnes
- Certificate of Calibration



MODEL	Capacity Tonne (Metric)	A (ø)		B		C		D		E		Weight Kg lbs
		mm	mm	mm	mm	mm	mm	mm	mm	mm		
		in	in	in	in	in	in	in	in			
JCM-5LC	5.0	26	226	130	293	39	2.6					
		1.02	8.89	5.11	11.53	1.53	5.7					
JCM-12.5LC	12.5	44	226	130	324	50	5.3					
		1.73	8.89	5.11	12.75	1.96	11.7					
JCM-25LC	25.0	55	290	136	430	61	7.1					
		2.16	11.41	5.35	16.92	2.40	15.7					
JCM-35LC	35.0	61	290	140	440	70	9.4					
		2.40	11.41	5.51	17.32	2.75	20.7					
JCM-50LC	50.0	75	304	170	480	85	15.0					
		2.95	11.96	6.69	18.89	3.34	33.0					
JCM-75LC	75.0	86	306	190	500	100	17.0					
		3.38	12.04	7.48	19.68	3.93	37.5					
JCM-100LC	100	100	346	194	556	124	26.1					
		3.93	13.62	7.63	21.88	4.88	57.5					
JCM-150LC	150	120	396	244	680	127	47.1					
		4.72	15.59	9.60	26.77	5.00	104					
JCM-200LC	200	132	442	280	784	150	79.0					
		5.19	17.40	11.02	30.86	5.90	174					
JCM-300LC	300	160	582	400	1000	150	TBA					
		6.29	22.91	15.74	39.37	5.90	TBA					
JCM-400LC	400	180	614	400	1098	200	TBA					
		7.08	24.17	15.74	43.22	7.87	TBA					
JCM-500LC	500	190	600	490	1100	200	TBA					
		7.48	23.62	19.29	43.30	7.87	TBA					

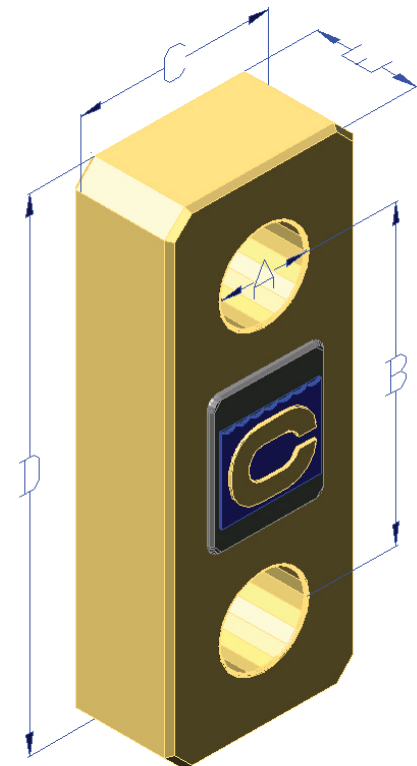

CANFLEX (USA) INC 412 30th Street • P.O. Box 1014 • Anacortes Washington 98221

Tel: 206-282-8233 or 800-544-8356 • Fax 206- 282-5933 or 800-635-6992 canflex@direct.ca / www.canflexinc.com